

# Standard Screw Pin Shackle

Bow shackles with screw collar pin

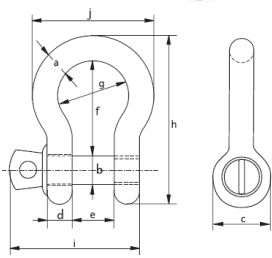

## Certification

At no extra charge, this product can be supplied with a works certificate, 3.1 material certificate, manufacturer test certificate, EC Declaration of Conformity and all shackles starting from 2 tons can be supplied with DNV 2.7-1 certificate.

### Material:

Bow and pin high tensile steel, Grade 6, quenched and tempered

### Temperature:

-20 °C up to +200 °C

### Safety Factor:

MBL equals 6 x WLL

### Standard:

EN 13889 and meets performance requirements of US Fed. Spec. RR-C-271 Type IVA Class 3, Grade A hot dipped galvanized

## Specifications

Working Load Limit (tons)	Diameter Bow a (mm)	Diameter Pin b (mm)	Diameter Eye c (mm)	Width Eye d (mm)	Width Inside e (mm)	Length Inside f (mm)	Width Bow g (mm)	Length h (mm)	Length Bolt i (mm)	Width j (mm)	Weight Each (kg)
0.33	5.0	6	12	5.0	9.5	22.0	16	36	29.5	26	0.02
0.5	7.0	8	16.5	7.0	12.0	29.0	20	48.5	38	34	0.05
0.75	9.0	10	20	9.0	13.5	32.0	22	56	46.5	40	0.1
1.0	10.0	11	22.5	10.0	17.0	36.5	26	63.5	54	46	0.14
1.5	11.0	13	26.5	11.0	19.0	43.0	29	74	59.5	51	0.19
2.0	13.5	16	34	13.0	22.0	51.0	32	89	73	58	0.36
3.25	16.0	19	40	16.0	27.0	64.0	43	110	89	75	0.63
4.75	19.0	22	46	19.0	31.0	76.0	51	129	103	89	1.01
6.5	22.0	25	52	22.0	36.0	83.0	58	144	119	102	1.5
8.5	25.0	28	59	25.0	43.0	95.0	68	164	137	118	2.21
9.5	28.0	32	66	28.0	47.0	108.0	75	185	153	131	3.16
12.0	32.0	35	72	32.0	51.0	115.0	83	201	170	147	4.31
13.5	35.0	38	80	35.0	57.0	133.0	92	227	186	162	5.55
17.0	38.0	42	88	38.0	60.0	146.0	99	249	203	175	7.43
25.0	45.0	50	103	45.0	74.0	178.0	126	300	243	216	12.84
35.0	50.0	57	111	50.0	83.0	197.0	138	331	272	238	18.15
42.5	57.0	65	130	57.0	95.0	222.0	160	377	310	274	26.29
55.0	65.0	70	145	65.0	105.0	260.0	180	433	344	310	37.6